

District of Barriere

PLANNING REPORT

Date: May 3, 2021	File: 530.20/Rpts
To: Council	From: T. Buchanan, Corporate Officer
Re: Development Permit re: Barriere Motor Inn 4347 Yellowhead Hwy - DP-21-01 BMI	

Background: Properties located along the Yellowhead Highway Corridor are subject to District of Barriere Development Permit requirements for new or changing building exteriors and property layouts.

Discussion: An application has been submitted by the owner of 4347 Yellowhead Highway for an addition of an uncovered, licensed patio on the south side of the Barriere Motor Inn as an extension to the Armour Mountain Pub. The plan is for a 15' x 24' uncovered, fully railed patio to meet compliance with Interior Health regulations for outdoor restaurant patios. Due to the pandemic, many of these types of applications from restaurants are being seen throughout the Province.

Interior Health, BC Hydro and Ministry of Transportation and Infrastructure have no issue with the application.

Recommendation: That Council approve DP-21-01 for a licensed outdoor patio at 4347 Yellowhead Highway as presented.

Attachments:
Layout Sketch

SKETCH PLAN OF PROPOSED DELIVERY TRUCK PATHS ON LOTS 2 AND 3, DL 1325 KDYD PLAN EPP108201



ALL DISTANCES ARE IN METRES AND DECIMALS THEREOF

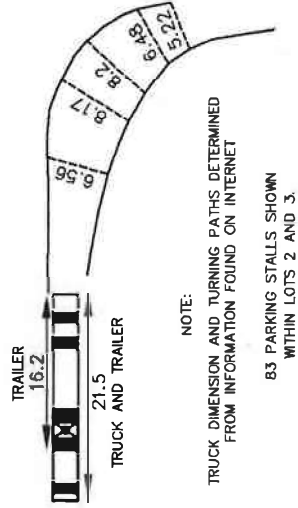
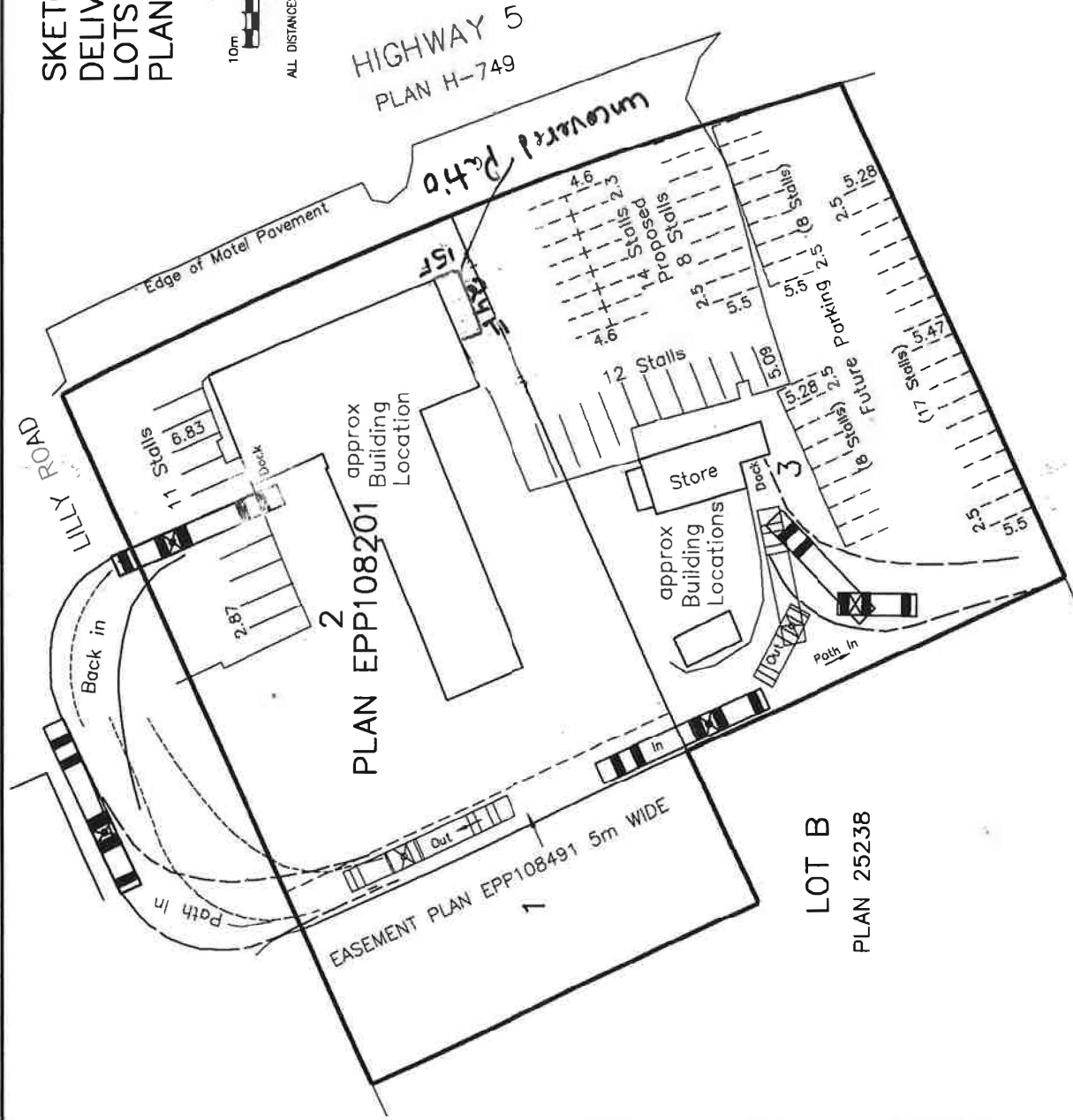
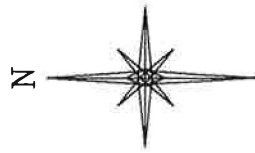

CAD FILE: T05285-SK-RS.DWG. (Feb 25/20)

UNDERHILL & UNDERHILL
PROFESSIONAL LAND SURVEYORS
201-925 McMASTER WAY
KAMLOOPS, B.C. V2C 6K2
TEL (250) 372-8835

THIS PLAN LIES WITHIN THE
THOMPSON-NICOLA REGIONAL DISTRICT

DRAWN BY: BD

F.B. 729

Pg. 133-136

FILE NO. K20-232

T05285